

# SYSTEM COMPONENTS 1/4" - 2" BHNV-02,24,26, HOSE, PT

## DRAIN VALVE "BHNV"

### TRI FLO TECH SPECIFICATIONS:

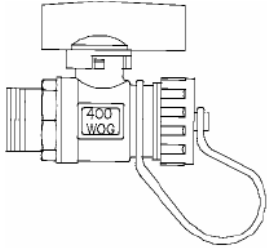

**PSI / Temperature Rating:** 400 WOG (300 PSI, 260°F)

**Body and Cap Material:** Brass  
**Ball Valve:** Nickel-plated brass ball  
**End Connection:** NPT  
**Cap Connection:** 3/4" NPSH  
**Handle Rotation:** Straight is open. Rotate clockwise to close 1/4 turn. 1/4"  
**Part Number:** BHNV-02, 1/2" BHNV-24

## FIRE RATED HOSE

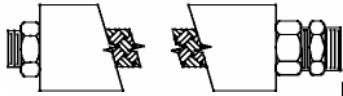

### TRI FLO TECH SPECIFICATIONS:

**PSI / Temperature Rating:** 1/2":390 PSI, 3/4":326 PSI, 1":260 PSI, 1-1/4":218

**PSI @ 218°F; 1-1/2":175 PSI, 2":150 @ 218°F Material:** Polymer wrapped with

stainless steel braid

**End Connection:** MNPT x MNPT Swivel End

### ACCESSORY OPTIONS:

**Insulation R Value:** 1/2":2.1, 3/4":2.0, 1":1.8, 1-1/4":1.7, 1-1/2":1.6, 2":1.5

Part#	1/2"	3/4"	1"	1-1/4"	1-1/2"	2"	1/2"Ins	3/4"Ins	1"Ins	1-1/4"Ins	1-1/2"Ins	2"Ins
12"	7486-22	7486-16	7486-23	-	-	-	8517-18	8517-19	8517-20	-	-	-

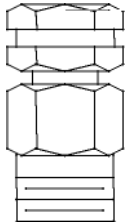

18"	7386-01	7486-02	7486-03	7586-04	7486-05		8517-01	8517-02	85-17-03	8517-04	8517-05	-
24"	7486-06	7486-07	7486-08	7486-09	7586-10	7486-1	8517-06	8517-07	8517-08	8517-09	8517-10	8517-21
36"	7486-11	7486-12	7486-13	7486-14	7486-15	7	8517-11	8517-12	8517-13	8517-14	8517-15	8517-22

## PRESSURE/TEMPERATURE TEST VALVE "PT"

### TRI FLO TECH SPECIFICATIONS:

**PSI / Temperature Rating:** 1000 PSI / 360°F **Body and Cap Material:**

**Brass Seal:** Nordel

**End Connection:** 1/4" NPT

**Part Number:** TFT-PT-26

## MANUAL AIR VENT "BHNV-26"

### TRI FLO TECH SPECIFICATIONS:

**PSI / Temperature Rating:** 1000 PSI / 360°F

**Body:** Brass

**End Connection:** 1/4" NPT

**Part Number:** TFTBHNV-26